

# NOTICE OF COMPLETION

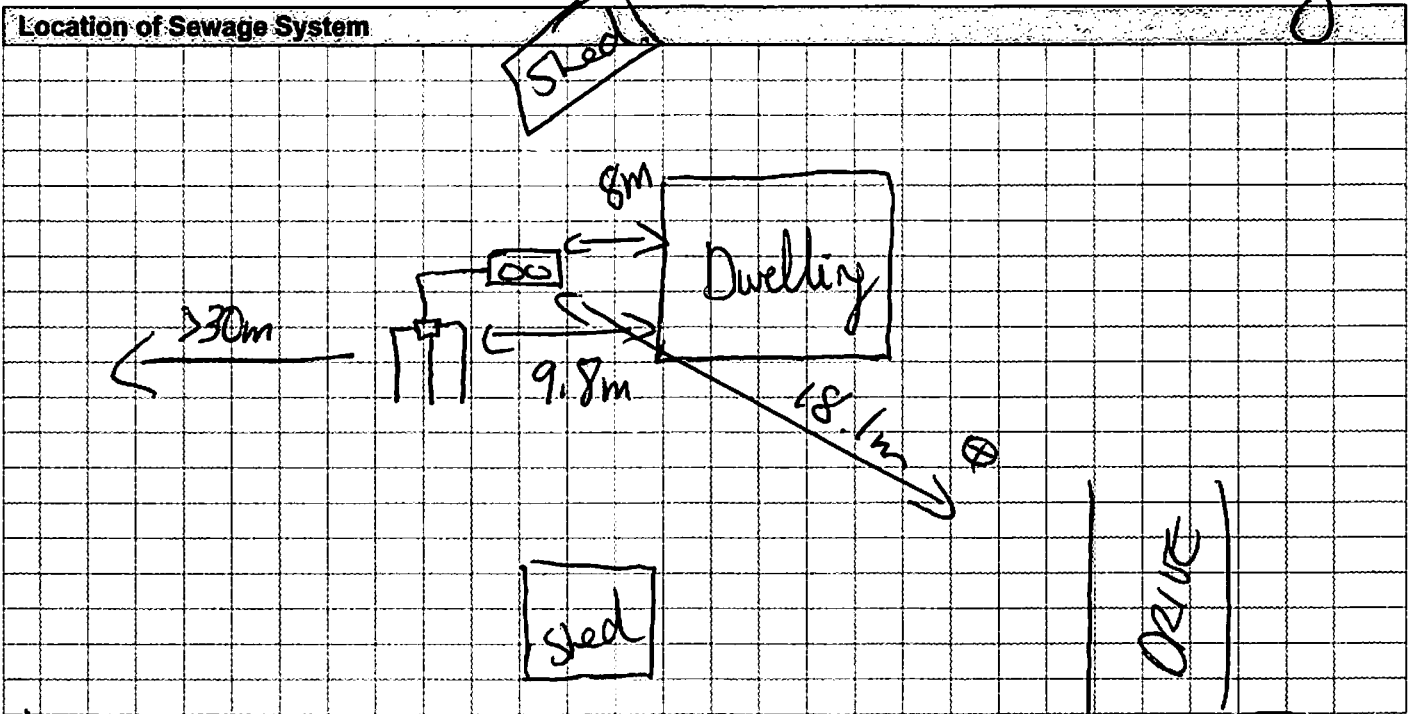

SEWAGE SYSTEM PERMIT # 8-ST-16

<b>Project Information</b>			
Property Owner's name		Telephone	
Building number, street name		Unit no.	Postal code
Municipality	Lot/Conc.	Plan number/ other description	
Roll Number			
<b>Dwelling Information</b>			
Bedrooms	Floor Area	Fixture Units	Native Soil T Time
1	60m <sup>2</sup>	7.5	15
Class of System		Description	
4F		Filter Bed System	
Tank Size	Bed Size	Extended Contact Area	Mantle Load Area
3000 L	11.2 m <sup>2</sup>	15.0 m <sup>2</sup>	Existing



<b>Substantial Completion of Installation Approval</b>		
Inspection Date	Inspector	I/CBQ-SS
July 18/17	[Signature]	[Signature]
Remarks		

<b>Site Evaluation Completion Approval</b>		
Inspection Date	Inspector	
Aug 17/17	[Signature]	
Remarks		

69 Bowes Street Parry Sound, Ontario P2A 2L5 P: (705) 746-7566 F: (705) 746-7553 www.nbmca.on.ca  
 15 Janey Avenue North Bay, Ontario P1C 1N1 P: (705) 474-5420 F: (705) 474-9793 www.nbmca.on.ca

WHITE – Office      CANARY – Contractor      PINK – Municipality      GOLDENROD – Owner

July 14/17 16.840kg LH

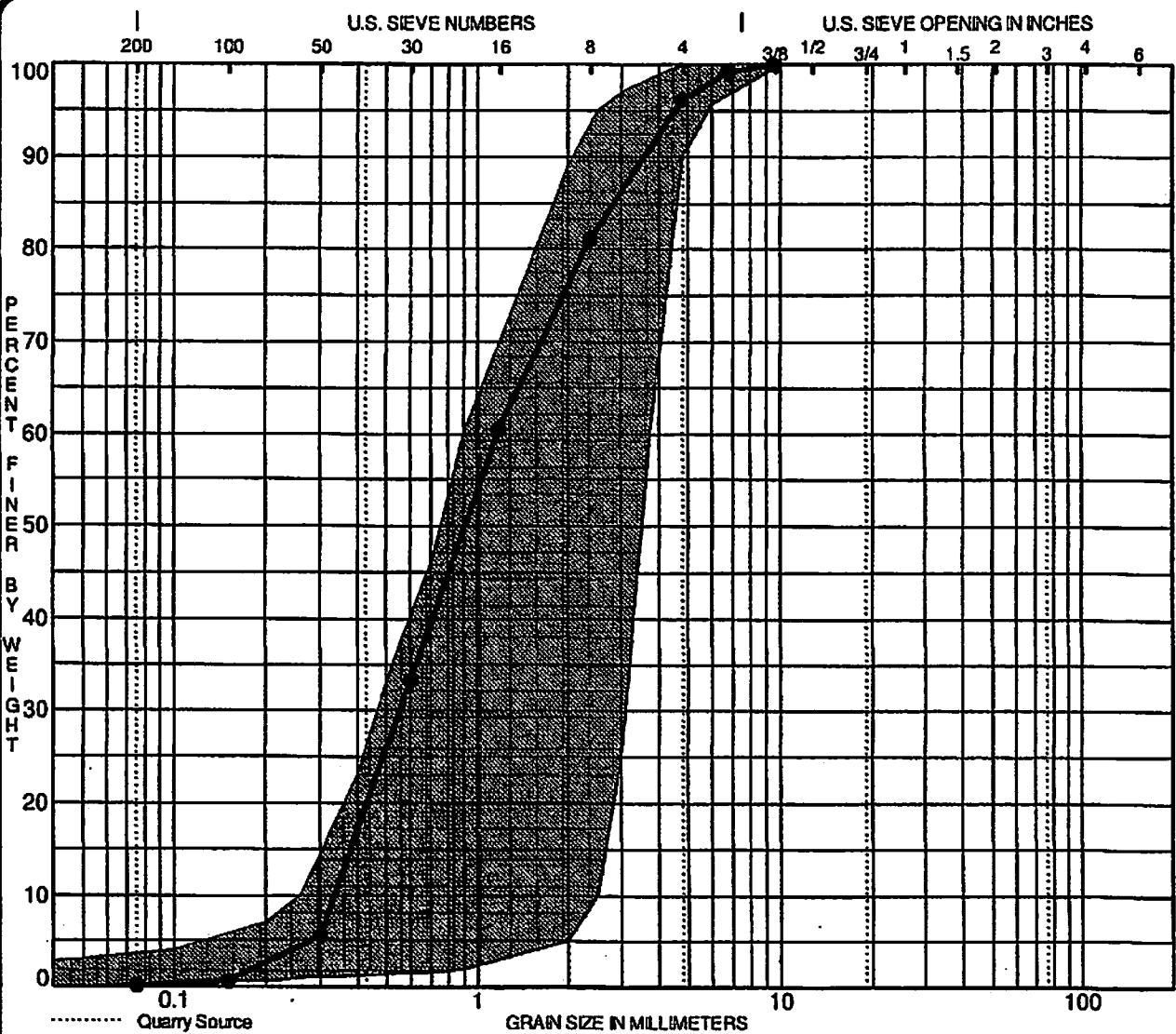

SILT	SAND			GRAVEL		COBBLES
	fine	medium	coarse	fine	coarse	

Specimen Identification	Classification	MC%	LL	PL	PI	Cc	Cu
● 68929	FILTER MEDIA SAND (PIT 11)					0.78	3.5

☐							
▲							
★							

Specimen Identification	D100	D60	D30	D10	%Gravel	%Sand	%Silt	%Clay
● 68929	9.50	1.17	0.554	0.3355	3.9	95.9	0.2	

CLIENT	<u>Miron Topsoil</u>	FILE NO.	<u>NM1348</u>
PROJECT	<u>Laboratory Testing -</u>	DATE	<u>23 Jun 15</u>

**patersongroup** Consulting Engineers  
 154 Colonnade Road South, Ottawa, Ontario K2E 7J5

**GRAIN SIZE DISTRIBUTION**

# INSPECTION NOTICE

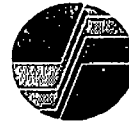

NORTH BAY-MATTAWA  
CONSERVATION  
AUTHORITY

Permit #: 8-57-16

Owner Name: 

Based on the observations and measurements taken by the inspector, it has been determined that the inspection has:



**INSPECTION PASSED**



**INSPECTION FAILED**

**PASS** – The inspector finds that any/all components of the sewage system application/installation are compliant with manufacturer specifications, the approved permit, and the Ontario Building Code regulations. This serves as written notice that the inspection has passed and that all conditions are satisfied and/or that the system is substantially complete and approved for backfill.

**Note: A third inspection is required to complete the permitting process after the sewage system is substantially complete and approved for backfill.**

**FAIL** – The inspector has determined that there are components of the sewage system application/ installation that do not meet the specified requirements. These deficiencies are outlined below:

---

---

---

---

---

**FOLLOW-UP ACTION REQUIRED:**

Submit Additional Documents

Schedule Re-Inspection (additional fee applies)

Do Not Backfill until Re-Inspection

Your timely regard to this matter will assist the NBMCA in working with you to advance your Building Permit.

**NORTH BAY-MATTAWA CONSERVATION AUTHORITY (NBMCA)**

Inspected by 

(SSI)

BCIN #

20737

Dated: 18,

(day)

07,

(month)

20

17

WHITE – Office

CANARY – Owner/Installer

# THIS WORK IS AUTHORIZED

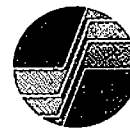

**NORTH BAY-MATTAWA  
CONSERVATION  
AUTHORITY**

**ONSITE SEWAGE SYSTEM PERMIT  
MUST BE POSTED PRIOR TO CONSTRUCTION**

PERMIT #  
**8-ST-16**

## THIS WORK IS AUTHORIZED FOR THE CONSTRUCTION OF AN ONSITE SEWAGE SYSTEM

- New Construction
  - Replacement / Alteration
  - Demolition of an Onsite Sewage System
  - Conditional Permit (see conditions)
- Subsurface Detection  
Required (header & wing)*

Property Owner: [REDACTED]  
 Address: **228 Pevensey Rd.**  
 District / Twp: **Parry Sound, Strong**  
 Roll #: **49-46-001-010-045-00-0000**  
 Legal Desc: **lot 10, Con. 1, Pt 1, 42R10555**

STAMP

### MANDATORY INSPECTIONS - Failure to request mandatory inspections may be subject to penalties.

- Substantial Completion of Installation**  
 Current Filter Graphs must be submitted to the NBMCA prior to scheduling a substantial completion inspection.  
 The following **MUST BE FULLY EXPOSED** prior to inspection:
  - Tanks
  - Distribution box
  - Any/all increased contact area
  - Geotextile or untreated building paper on site
  - All distribution pipes
  - Pumps, pump chamber and alarms installed and operational
- Final Completion Inspection:** Grading of side slopes, mantle complete.  
 Topsoil and shallow rooted vegetation covering a minimum 60% of system including the mantle.

#### NBMCA Office Use Only

Inspected and Recommended by: *[Signature]* (SSI)  
 Dated: (day/month/year): **31, 08, 20 16**  
 Approved by: *[Signature]* (NBO 0077 (Vdco-cs))  
**PERMIT EXPIRATION DATE:** (day/month/year): **31, 08, 20 17**

69 Bowes Street Parry Sound, Ontario P2A 2L5 P: (705) 746-7566 F: (705) 746-7553 www.nbmca.on.ca  
 15 Janey Avenue North Bay, Ontario P1C 1N1 P: (705) 474-5420 F: (705) 474-9793 www.nbmca.on.ca

# Onsite Sewage System

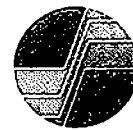

**NORTH BAY-MATTAWA  
CONSERVATION  
AUTHORITY**

# PERMIT (Page 2)

Total Number of Bedrooms	1
Total Floor Area of Buildings (m <sup>2</sup> )	60m <sup>2</sup>
Total Fixture Units	7.5

Description of Fixture	Total # Fixtures
Sink(s)	2
Toilet(s)	1
Bath Tub/Shower (s)	0
Machine(s)	0
Other	0

**CLASS 2 - GREYWATER PIT - PERMIT #**

Calculated Sidewall Area: \_\_\_\_\_ m<sup>2</sup>

Dimensions of Pit: Length \_\_\_\_\_ m / Width \_\_\_\_\_ m / Depth \_\_\_\_\_ m

**SEPTIC TANK - PERMIT #** 8-ST-16

New:  Existing: \_\_\_\_\_ Volume of Tank: 3600 Litres

**TREATMENT UNIT - PERMIT #**

Make/Model: \_\_\_\_\_ Operating Capacity \_\_\_\_\_ Litres/Day

**CLASS 4 TRENCH BED - PERMIT #**

Raised Bed: Yes No Raised Height of Bed: \_\_\_\_\_ m

Imported Mantle: Yes No Size of Mantle Required: \_\_\_\_\_ m<sup>2</sup>

Approved for Pump: Yes No Total Length of Pipe: \_\_\_\_\_ m

**CLASS 4F FILTER BED - PERMIT #** 8-ST-16

Raised Bed:  Yes  No Raised Height of Bed: 0.9 m

Imported Mantle: Yes  No Size of Mantle Required: 75.0 m<sup>2</sup>

Approved for Pump: Yes  No Filter Bed Area: 10.0 m<sup>2</sup> Size of Contact Area: 14.0 m<sup>2</sup>

**CLASS 5 HOLDING TANK** Size of Tank: \_\_\_\_\_ Litres

**OTHER TREATMENT UNIT / AREA BED - PERMIT #**

Make/Model: \_\_\_\_\_ Model Flow Rate: \_\_\_\_\_ Litres/Day

Raised Height: \_\_\_\_\_ m Stone Area: \_\_\_\_\_ m<sup>2</sup> Sand Area: \_\_\_\_\_ m<sup>2</sup>

**NBMCA OFFICE USE ONLY**

Inspected/Recommended by: \_\_\_\_\_ Approved by: \_\_\_\_\_  
(SSI) (NCSO-SS) / (rdcto-ss)

DATED: (day/month/year) 31-08-2016 EXPIRY: (day/month/year) 31-08-2017

69 Bowes Street Parry Sound, Ontario P2A 2L5 P: (705) 746-7566 F: (705) 746-7553 www.nbmca.on.ca  
 15 Janey Avenue North Bay, Ontario P1C 1N1 P: (705) 474-5420 F: (705) 474-9793 www.nbmca.on.ca

1-228 PEVENSEY RD.-LOT 10, CON 1-42R 10555, PART 1-STRONG TWP.

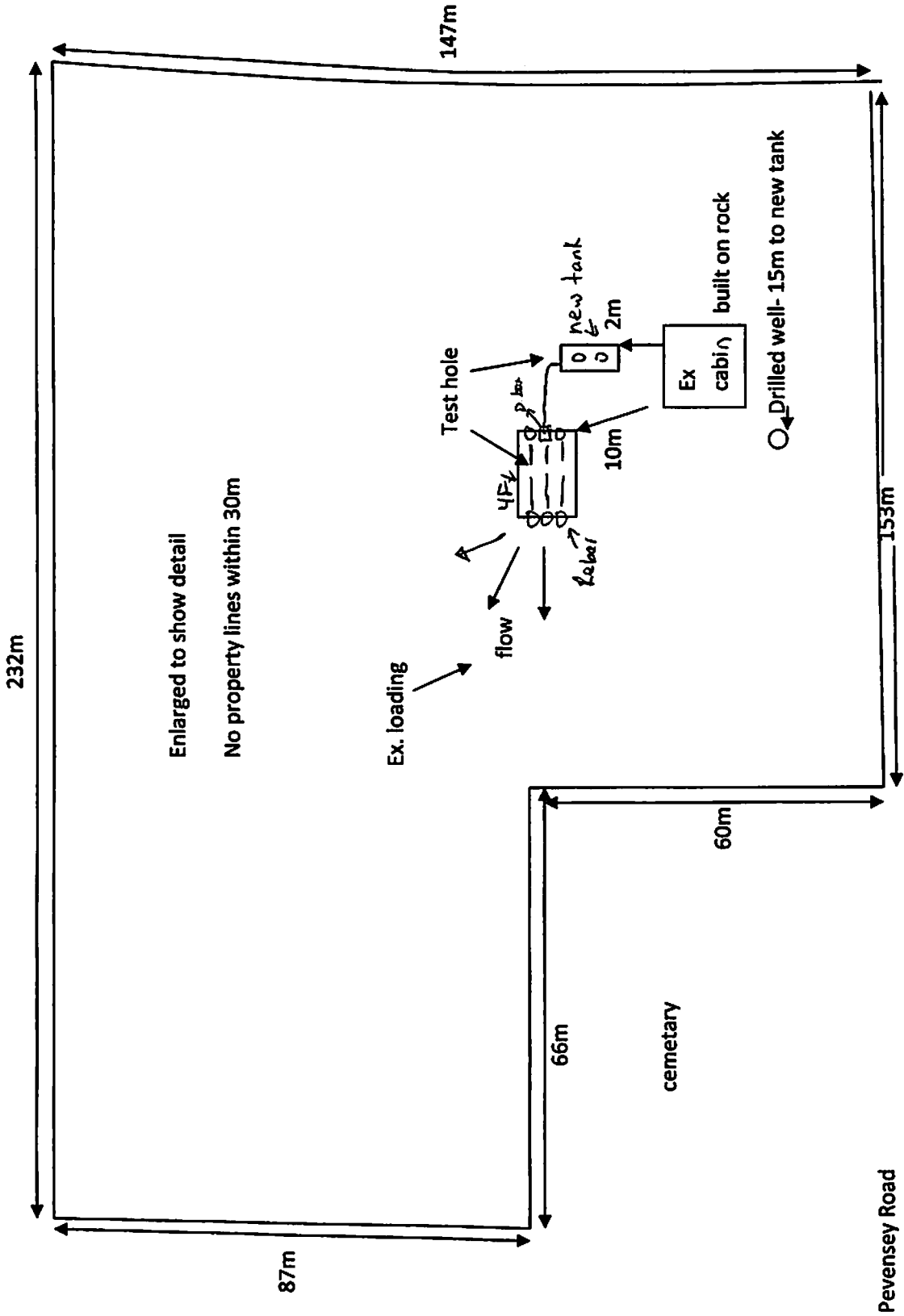

228 PEVENSEY RD.-LOT 10, CON 1-42R 10555, PART 1-STRONG TWP

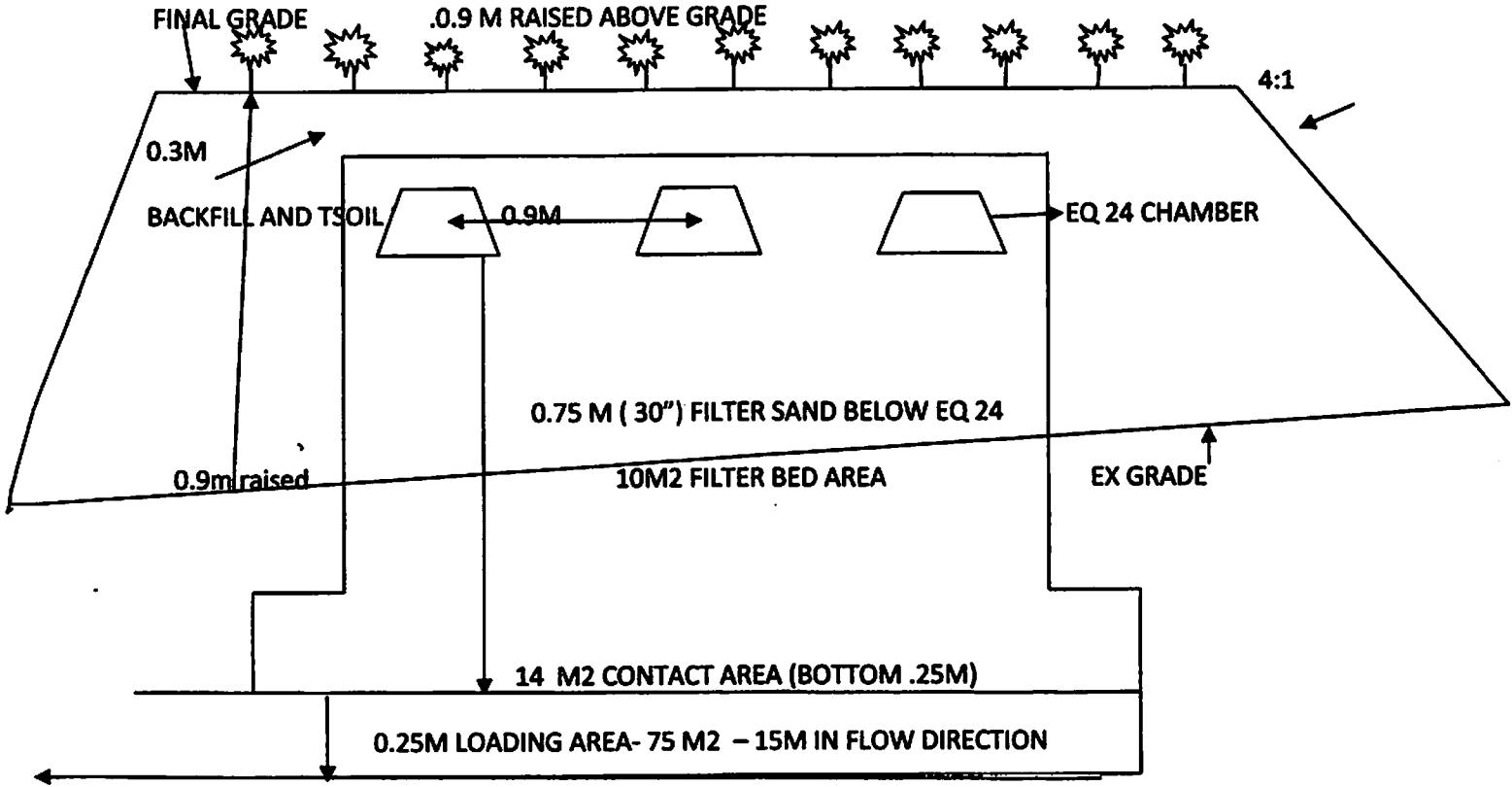

3 INFILTRATOR EQ 24 CHMABERS @ 0.9M CENTRES

2 CHAMBERS PER ROW = 2.7M WIDE X 3.8M LONG =10M2 BED AREA

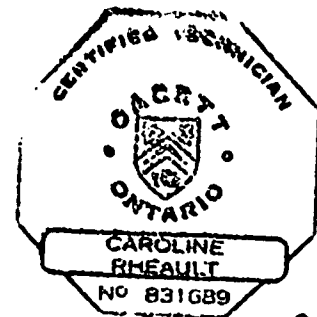

*Caroline Rheaault*