

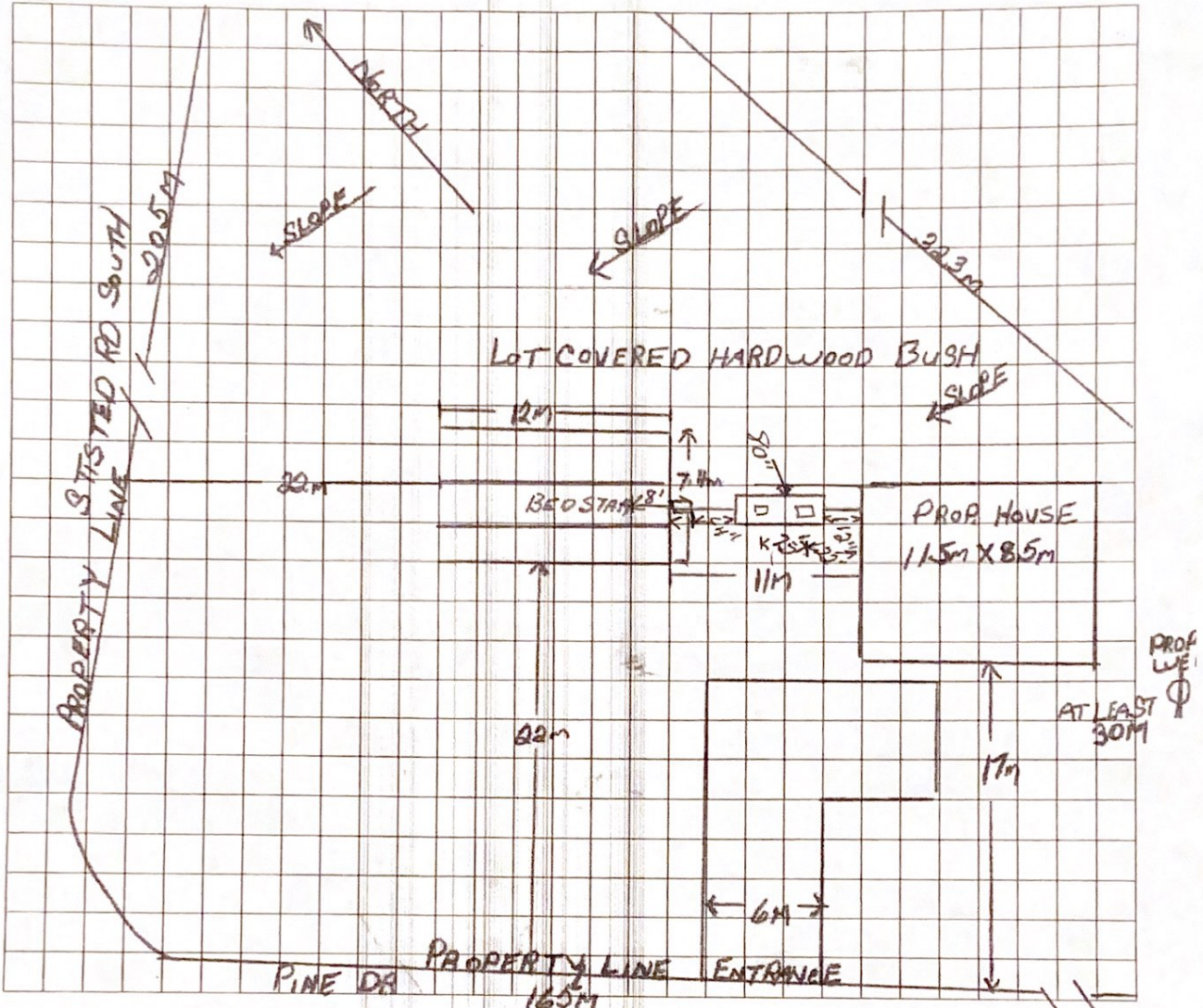

NELSON

12. LOT DIAGRAM AND SEWAGE SYSTEM PLAN: Draw to scale indicating north point and showing:
- (a) Location of sewage system components (eg. tanks, leaching bed). Locate and show horizontal distances from system to adjacent existing or proposed buildings, water supplies (including neighbours), existing on-site sewage systems, driveways, property lines, lakes, rivers, water courses, swimming pools.
 - (b) Lot dimensions, topographic features (e.g. swamps, steep slopes) near system.
 - (c) If any part of proposal conforms to specific standard drawing, give reference number(s).



A Certificate of Approval for this application is refused for the reasons given in Section 11 Page 1

Inspected and Recommended by

Refused

Date

Director

CERTIFICATE OF APPROVAL

Application approved and this Certificate of Approval under Section 77 of the Environmental Protection Act is hereby issued for the proposal outlined on Pages 1 and 2 of the application and its attachments as amended by the requirements and conditions of Section 11 provided that the sewage system shall be completed and a Use Permit issued within 12 months of the issue hereof or such extended period as the Director on application allows. DO NOT OPERATE THE SYSTEM UNTIL A USE PERMIT IS ISSUED.

Inspected and Recommended by

Issued

Date

David Nelson

[Signature]

Director

Dec 22/97

Under Section 139 of the Environmental Protection Act, an applicant may appeal a decision by writing to the Director and to the Environmental Appeal Board, 112 St. Clair Avenue West, Suite 502, Toronto, Ontario, M4V 1N3 within 15 days of receipt of the decision.